

# SOUTH PLAINS OBEDIENCE TRAINING CLUB OF LUBBOCK AGILITY TRIAL PREMIUM LIST

Licensed by the American Kennel Club

***This Event is Accepting Entries for All AKC-Recognized Breeds and  
Dogs Listed in the AKC Canine Partners Program (Mixed Breeds)***



**Friday, Saturday, Sunday  
November 11, 12, 13, 2022**

EVENT NUMBERS

2022269113, 2022269114, 2022269115

TEXAS TECH EQUESTRIAN CENTER  
5712 CR 1500  
Lubbock, TX 79407

**TO BE HELD INDOORS ON PACKED DIRT – NOT CLIMATE CONTROLLED**

---

---

<b>ENTRY LIMIT:</b>	350 Runs per day; 2 Alternating Rings
<b>ENTRY METHOD:</b>	First Received; <b>ACCEPTING AKC ONLINE ENTRIES*</b> (See Details Inside)
<b>TRIAL SECRETARY:</b>	Sherri Farmer, PO Box 1720, Wylie TX 75098-1720
<b>OPENING DATE:</b>	Wednesday, September 7, 2022, 8:00 AM
<b>CLOSING DATE:</b>	Wednesday, October 26, 2022, 6:00 PM, after which time entries cannot be accepted, cancelled, altered or substituted except as provided for in Chapter 11, Section 6 of the Dog Show Rules and Chapter 1, Section 16 of the Regulations for Agility Trials. (as of Sept. 1, 2010)
<b>TRIAL HOURS:</b>	<b>Trial hours are 1 hour prior to start time, and 1 hour after conclusion of runs. Runs start no earlier than 8:00 am all 3 days</b>
<b>MOVE-UPS:</b>	Pre-trial move-ups must be submitted no later than Monday, November 7, 2022 at 6:00 PM
<b>CLASSES:</b>	<b>FRI : All Levels STD, JWW, Premier STD &amp; JWW, T2B, FAST SAT: All levels of STD, JWW, Premier STD &amp; JWW, and T2B SUN: All levels of STD, JWW, (no Premiers) and FAST</b>
<b>OFFERING:</b>	<b>For Exhibition Only (FEO) will be offered in FAST &amp; T2B</b>

---

---

## CERTIFICATION

Permission is granted by the American Kennel Club for the holding of this event under American Kennel Club Rules and Regulations. Gina DiNardo, Secretary



## ENTRY INFORMATION

### YOU CAN ENTER THE TRIAL VIA AKC'S ONLINE ENTRY SERVICE

Go to the AKC Agility Online Entry Services home page at [www.akc.org/AgilityEntry](http://www.akc.org/AgilityEntry) and follow the instructions there to use your 'My AKC' account to enter this event online. . (Please note that AKC charges a small processing fee for online entries.) During the first 48 hours after opening, the initial limit of entries designated as either online or paper will be as follows: 125 online entries and 225 paper entries. If either form of entry (paper or online) has not filled at the end of the 48 hour time period, the club reserves the right to decrease or increase either one accordingly.

You can also find detailed instructions at: [www.nxagility.com](http://www.nxagility.com)

\*\*\*Hand deliveries cannot be accepted during the first 24 hours after the trial's opening.\*\*\*

- Limit: 10 entries per envelope. One entry = one dog. Envelopes containing more than 10 entries will be returned.
- Paper entries received within 24 hours of the opening date & time must: 1) include postage or be metered; 2) be delivered by a multi-state or multi-national postal or carrier service, including but not limited to USPS, FedEx, UPS & DHL. If above conditions are not met, the entries are not valid and must be returned to sender. **You must waive signature requirements when using services that utilize signature verifications.**
- Owners are responsible for ensuring that entry forms are completed IN FULL. Entries submitted without ALL information will be returned as invalid.
- All entries must be submitted on official AKC agility entry forms, one dog per entry form. Photocopies of entry form will be accepted only if legible and official AKC size.
- Entries will not be accepted without signature, fees and reverse side of entry form with agreement signed, nor will credit cards or faxed entries be accepted with paper entries.
- Returned checks do not constitute a valid entry; no refund for duplicate entries. Returned checks do not constitute a valid entry fee. There will be a \$25 service charge for returned checks.

## JUMP HEIGHT CARD PROCESS

**PLEASE DO NOT SEND A COPY OF YOUR  
JUMP HEIGHT CARD WITH YOUR ENTRY.**

**ENTRY FORM:** The AKC entry form has a section at the top of the form for exhibitors to designate whether your dog has a valid jump height card or if your dog needs to be measured. Please check the appropriate box so the Trial Secretary knows whether to include your dog on the *Dogs To Be Measured List*.

All agility dogs are required to have an Official Jump Height Card/Valid yellow form and exhibitors must be able to present it at any time during the trial **upon request**. All dogs that have not been officially measured for an Agility Jump Height Card may still compete; however, they must be measured by a Judge of record, an Agility Field Representative, or a Volunteer Measuring Official, prior to running. If measured by the Judge of record, that measurement will be valid for this trial *or back-to-back trials* only. However, if a **Volunteer Measuring Official (VMO)** or an **Agility Field Rep** is present; **ALL** dogs without a valid Jump Height Card/Form **must** be measured at some time during the trial or cluster of trials. **If a measurement is necessary, it is the exhibitor's responsibility to have their dog measured prior to running and failure to do so will result in the cancellation of any qualifying scores.**

## SPOTC 2022 BOARD OF DIRECTORS

President..... Dana Brown  
 Vice President..... Mary Jane Sampson  
 Secretary..... 5424 22nd St. Lubbock, TX ..... Jodi Pritchard  
 Treasurer..... Cheryl Birdwell  
 Board of Directors: ..... Teresa Janssen, Julie Wilson, Gail Claborn, Mary Lou Vardy,  
 Margaret Freeman

### *Agility Trial Chair*

**Teresa Janssen**  
 7601 Highway 84  
 Shallowater, TX 79363  
 806.786.8661  
[tjanssen05@gmail.com](mailto:tjanssen05@gmail.com)

### *Agility Trial Secretary*

**Sherri Farmer**  
**Donna Todd, Associate**  
**North Texas Agility**  
 PO Box 1720  
 Wylie TX 75098-1720  
 972.841.4066  
[ntxagility@verizon.net](mailto:ntxagility@verizon.net)

## EVENT COMMITTEE

Teresa Janssen, Chair, Cheryl Birdwell, Gail Claborn, Dana Brown, Coye McCleskey, Margaret Freeman and all members present at the trial.

**Premiums, Fillable Entry Forms, Judging Programs, Running Order, Complete Results After the Trial, Instructions for using the AKC Online Entry System, etc., can be found at:**

[www.nxagility.com](http://www.nxagility.com)

## JUDGING ASSIGNMENT FOR ALL CLASSES

**JUDGE:** Ms. Karen Wlodarski (#90984), 2743 Old Oak Walk, Johns Island, SC 29455  
 Ms. Wlodarski is a VMO (Measuring Official)

**TENTATIVE RUNNING ORDER - SUBJECT TO CHANGE – RINGS WILL ALTERNATE.**

**Small-to-Tall on Friday and Sunday; Tall-to-Small on Saturday**

<b>FRIDAY</b>	<b>SATURDAY</b>	<b>SUNDAY</b>
Ring 2 - All FAST	Ring 1 –T2B	Ring 1 –All FAST
Ring 1 –T2B	Ring 2 –Premier JWW	Ring 2 - Exc/Mas JWW
Ring 2 – Premier JWW	Ring 1 – Premier STD	Ring 1 - Exc/Mas Std
Ring 1 Premier Std	Ring 2 - Exc/Mas JWW	Ring 2 –Open JWW
Ring 2 –Exc/Mas JWW	Ring 1 - Exc/Mas Std	Ring 1 –Open Std
Ring 1 - Exc/Mas Std	Ring 2 –Open JWW	Ring 2 –Novice JWW
Ring 2 Open JWW	Ring 1 –Open Std	Ring 1 –Novice Std
Ring 1 Open STD	Ring 2 –Novice JWW	
Ring 2 Novice JWW	Ring 1 –Novice Std	
Ring 1 Novice STD		

All FAST Classes will be nested and walked/run together pursuant to the amended AKC rules effective January 3, 2017. Novice FAST will have 12 weave poles.

## ENTRY FEES

First entry of each dog (includes a \$3.50 AKC recording fee) ..... \$25.00  
 Additional entries of same dog (includes a \$3.00 AKC recording fee)..... \$15.00

## ENTRY CONFIRMATIONS & JUDGING PROGRAMS

An email confirmation will be sent at the time of processing if a legible, valid email address is provided on the entry form. Additional confirmations will be emailed to acknowledge move-ups and corrections/changes (prior to closing). A final confirmation and the judging program will be emailed after the trial closes. If you cannot receive a Microsoft Word text file, or if you do not check your email, do NOT include your email address. Printed confirmations and Judging Programs are mailed to exhibitors without email addresses after the trial closes. **OWNERS/HANDLERS ARE RESPONSIBLE FOR REVIEWING ALL INFORMATION IN THE CONFIRMATION LETTER EACH TIME IT IS SENT AND CONTACTING THE TRIAL SECRETARY IMMEDIATELY IN WRITING (EMAIL) IF A CORRECTION/CHANGE NEEDS TO BE MADE. CORRECT AKC REGISTRATION # OR ILP # IS CRUCIAL.**

**NOTE:** If you have a spam filter in place on your email account, please add the trial secretary's email address to your accepted address list. If you are not receiving emails from the trial secretary, it is your responsibility to notify the trial secretary to reach a resolution.

Any exhibitor who does not receive a preliminary confirmation within 10 days of mailing a paper entry should contact the Trial Secretary to confirm receipt of paper entry.

Any exhibitor who does not receive the Judging Program within five (5) days prior to the trial, should contact the Trial Secretary. Always bring a paper copy of your confirmation letter to the trial. Corrections to the confirmation letter that are not brought to the trial secretary's attention at the time of receipt will render the database as the final authority for the day's information.

## MOVE UPS

Dogs may be moved up to a higher class at the request of the owner, as a result of qualifying for an agility title, provided that the request is received in writing by the Trial Secretary, no later than 6 pm on the Monday preceding the event. (See the move-up deadline date on the cover of this premium). Day-to-day move ups are allowed provided the Trial Secretary is notified at the show site, in writing within 30 minutes of the last dog completing the course. Forms will be available at the show site.

**Please email pre-trial move-up requests to the trial secretary at [ntxagility@verizon.net](mailto:ntxagility@verizon.net) and please include the following information:**

- Your first and last name
- Your dog's call name
- The class and jump height to which you would like your dog moved

**Your request must be received by the deadline noted on the cover of this Premium**

## ARMBANDS NOT REQUIRED

Pursuant to Chapter 1, Section 19 of the Regulations for Agility Trials as amended in July 2016, competitors will NOT be required to wear armband stickers.

**WE**   
**VOLUNTEERS**

## PLEASE VOLUNTEER!!

SPOTC depends on volunteers to make this a great event. We love our volunteers and everyone is eligible to help at the trial. Don't worry if you've never done the job before – we'll be happy to show you. We will work with you to avoid ring conflicts – we want you to be stress free in the ring so you can have a great time!

**Volunteers receive coupons that can be redeemed in one of three ways:**

- 1) used for future entries in a SPOTC trial,
- 2) used at the concession stand, or
- 3) traded in for raffle tickets

**Volunteer coordinator – Dana Brown - [ddbrow@sbcglobal.net](mailto:ddbrow@sbcglobal.net)**

**A Google Doc will be posted on the internet for volunteers to fill in when/where they can work. A link will be emailed to all exhibitors after the schedule is set.**

**We appreciate all volunteers!!**

## CLASSES & TITLES OFFERED

Classes offered at this trial are listed on the front of this premium. Please see the AKC Regulations for Agility Trials for current class descriptions.

All exhibitors should obtain a copy of the Regulations for Agility Trials by contacting the American Kennel Club, 8051 Arco Corporate Drive, Suite 100, Raleigh NC 27617, by phone (919) 233-9767, by email at [info@akc.org](mailto:info@akc.org), or on their website at [www.akc.org](http://www.akc.org).

## ABOUT THE SHOW SITE

The Texas Tech Equestrian Center is an Indoor Arena with a Dirt arena surface. Please Park in designated Exhibitor parking areas only. Parking is a short distance from the arena, you may want to bring a cart/dolly.

**INDOOR SET UP RESTRICTIONS:** No matting allowed on concrete; matting is allowed on the dirt. Please cover crates with sheet from home. Please endeavor to keep barking at a minimum. No high-backed chairs (i.e. La Fuma style) lounge chairs allowed at ring side.

**DOGS ARE NOT ALLOWED TO BE OFF-LEAD ON THE ENTIRE EQUESTRIAN CENTER GROUNDS INCLUDING EMPTY PADDOCKS AND CORRALS. THE ONLY EXCEPTION IS AT THE PRACTICE JUMP AND IN THE RINGS. VIOLATORS WILL BE SUBJECT TO TRIAL COMMITTEE ACTION.**

## OBSTACLES AND RING CONDITIONS

Obstacles will meet the specifications for obstacles in the current edition of the regulations for Agility Trials. Complete rules can be printed out from the AKC website at [www.akc.org](http://www.akc.org). Go to Events, click on "Rules and Regulations". All AKC rulebooks are available for printing. All classes will take place indoors on a packed dirt surface. Ring size will be a minimum of 100' x 95'.

**CONTACT EQUIPMENT HAS RUBBERIZED SURFACES**

## TRIAL VETERINARIANS – ON CALL

Live Oak Animal Hospital  
5214 98th St Ste 100  
Lubbock, TX 79424  
806-794-9000

Mon-Fri: 8am-10pm Sat-Sun: 8am-5pm

Maps from the show site to the Emergency Vet Clinic will be at the Exhibitors table.

**EMERGENCY/ DISASTER PROCEDURES:** Our emergency coordinator will be on the grounds throughout the show. A list of emergency contacts will be posted and the coordinator will assist you in receiving whatever assistance is needed.

FIRE: 806-765-5757 For Emergency Call 911

POLICE: 806-763-5333 For Emergency Call 911

AMBULANCE SERVICE- EMS- 911

## AWARDS

Ribbons will be awarded to the 1st through 4th place dogs in each Standard, JWW, and FAST class and 1<sup>st</sup> place in each T2B class in each jump height. Qualifying ribbons will be awarded to dogs receiving qualifying score. Dogs must qualify to receive a placement ribbon.

New Title rosettes will be available for new titles earned at this trial. Also offering PAX Rosette and bar (while supply lasts).

MACH and PACH Rosettes, along with a MACH/PACH pole will be available for dogs earning those titles at this trial. Also offering a rosette and bar for the new AGCH title.

## VENDOR INFORMATION

We have limited space for vendors at our trial. Please contact Teresa Janssen at [tjanssen05@gmail.com](mailto:tjanssen05@gmail.com) to inquire about vendor space.

## EXHIBITOR INFORMATION

- Crating is available on concrete or dirt floor. **NO MATS ARE ALLOWED ON THE CONCRETE.**
- Seating (bleachers) are provided by the facility, but exhibitors may wish to bring their own comfortable chair.
- Crates may be left overnight; however, neither the club nor the facility will be responsible for any lost or damaged items left at the show site.
- Please keep your crating and parking areas clean.
- Exhibitors are responsible for cleaning up after their dog(s). Any exhibitor failing to do so may be excused without benefit of refund if the Trial Committee deems the exhibitor to be in violation of this requirement. Cleaning supplies and disposal sites will be available at various locations around the show grounds.
- Food concession is available on the site.
- Dogs may be brought to start line on slip leads, choke chains, body harnesses or other collars that are permitted on the trial grounds. Pinch/prong and electrical (dummy or not) are not allowed on the trial grounds.
- Handlers are permitted to walk the course, without a dog, prior to the start of the class. Each walk-through is restricted to handlers entered in that class/jump height.
- Running order will be determined by computer-generated random draw. Handlers with multiple dogs in one class will have those dogs separated as much as possible.
- All dogs present **must** be on leash or confined in crates when not being judged or at the warm up jump. **DOGS ARE NOT ALLOWED TO BE OFF-LEAD ON THE ENTIRE EQUESTRIAN CENTER GROUNDS INCLUDING EMPTY PADDOCKS AND CORRALS. THE ONLY EXCEPTION IS AT THE PRACTICE JUMP AND IN THE RINGS. VIOLATORS WILL BE SUBJECT TO TRIAL COMMITTEE ACTION.**
- Free parking is available for exhibitors. Park at your own risk.
- Exhibitors may wear shirts or insignia of their training group.
- The safety of the dogs is our primary concern. By entering this trial, exhibitors acknowledge that they are familiar with the rules and regulations of this sport, and that their dogs are familiar with and able to perform all the obstacles safely.
- The Club and the Trial Secretary have no obligation or responsibility to provide a public address system or stewards to call or locate dogs that are not present at the ring when required. Exhibitors are responsible for being at the gate when it is their turn to run.
- The Club and the Trial Facility assume no responsibility for any loss, damage or injury sustained by exhibitors, handlers or to any of their dogs or property and further assume no responsibility for injury to children.
- Exhibitors alone are responsible for the behavior of their dogs and/or children. Any exhibitor whose dogs and/or children create unnecessary disturbances or repeatedly engage in unsafe or disruptive behavior may, at the discretion of the Event Committee, be asked to leave the trial site. No refund of entry fees will be made.
- Dogs **may not** be left overnight at the trial site.

## SET-UP

SPOTC members will be setting up the rings on Thursday afternoon about 5:00. Anyone who is willing to help unload the trailers and set up the rings is welcome to set up their crates. **Please do not reserve spaces for people who are not helping!** Regular set up at 7:00 AM all 3 days.

## TRIAL HOURS

The trial grounds will be open at 7:00 am all 3 days. Judging will begin no earlier than 8:00 am all 3 days. Exact start times and running order will be determined after entries close and will be provided in the Judging Program.

## HEIGHT DIVISIONS

### HEIGHT DIVISIONS FOR REGULAR & PREFERRED CLASSES

Owners, exhibitors, and/or handlers are responsible for entering their dogs in the proper height division

HEIGHT DIVISIONS FOR REGULAR & PREFERRED CLASSES		
REGULAR	PREFERRED	FOR DOGS MEASURING...
8"	4"	11" & under at the withers
12"	8"	14" & under at the withers
16"	12"	18" & under at the withers
20"	16"	22" & under at the withers
24"	20"	Over 22" at the withers
24" Choice	N/A – Dogs in Preferred must jump their measured Preferred jump height.	Dogs may be entered in 24"-Choice at their owner's discretion – <b>Must be 22" or UNDER the withers.</b>

(Effective June 1, 2010) A dog which has been entered in a Novice "A" class for which it is not eligible to be entered in due to class restrictions on the dog or handler may be moved to the Novice "B" class under the following conditions:

- The request for the move must be in writing and presented to the superintendent or trial secretary at least 30 minutes prior to the start of each trial;
- The request must state the reason and justification for the move from a Novice "A" class to the Novice "B" class.

## REFUND POLICY

- Entry fees will be refunded if an entry is pulled before the closing date and time.
- No refunds will be made for any entry pulled after the closing date unless the spot is filled from someone on the wait list (see below).
- The club will provide full refunds less **\$10 PER DAY** processing fee for bitches in season or for a judge change (only for classes affected). For a bitch in season, veterinary verification in writing must be submitted to the Trial Secretary no later than 30 minutes before the start of the trials. Refunds will be mailed after the trial.
- Entry fees will not be refunded in the event that a dog is absent, disqualified, sick, lame, excused by veterinarian or judge, barred from competition by action of the Event Committee, is ineligible to compete due to being entered incorrectly or if a trial cannot open or be completed.
- Refunds for less than \$5 will not be made.
- Entry fees will not be refunded if the trial cannot open or be completed by reason of riots, civil disturbances, fire, an act of God, public emergency, act of a public enemy, or any other cause beyond the control of the organizing committee.

## WAIT LIST - REFUND POLICY

In the event the trial fills, we are offering a Wait List to fill openings created by withdrawn entries after the trial's closing date/time. A maximum of FIFTY (50) entries will be placed on the club's wait list. **All entries, including wait listed entries, must be received by the Trial Secretary prior to the trial closing date as listed on the front of this Premium. Any withdrawals that are received by 6:00 pm the Sunday prior to the first day of the trial will be replaced by a wait listed entry if any are available.** If a withdrawn entry is replaced by a wait listed entry, a full refund will be issued for the withdrawn entry. Any wait listed entry that does not move off the wait list into the trial by 6:00 pm the Sunday prior to the first day of the trial will receive a full refund.

## ELIGIBILITY

All dogs fifteen (15) months of age or older that are registered with the American Kennel Club or that have AKC Limited Registration, Purebred Alternative Listing/Indefinite Listing Privileges (PAL/ILP) or an AKC Canine Partners listing number, or approved Foundation Stock Service (FSS) breeds are eligible to participate. Refer to Chapter 2 of the Registration and Discipline Rules for the listing of registerable breeds that may participate. Wherever the word "dog" is used in these regulations, it includes both sexes. Dogs with a Purebred Alternative Listing/Indefinite Listing Privileges (PAL/ILP) or an AKC Canine Partners listing number must be spayed or neutered in order to compete.

Dogs should be physically sound. Dogs that are blind shall not be eligible, and neither are bitches in season, aggressive dogs, or dogs suffering from any deformity, injury, or illness which may affect the dog's physical or mental performance. No dog shall compete if it is taped or bandaged in any way or has anything attached to it for medical purposes. Dogs disfigured as the result of an accident or injury but otherwise qualified shall be eligible provided that the disfigurement does not interfere with functional movement. Three-legged dogs are eligible for entry at owner's discretion.

Exhibitors should follow their veterinarian's recommendation to assure their dogs are free of internal and external parasites, any communicable diseases and have appropriate vaccinations.



## DIRECTIONS TO THE TRIAL SITE

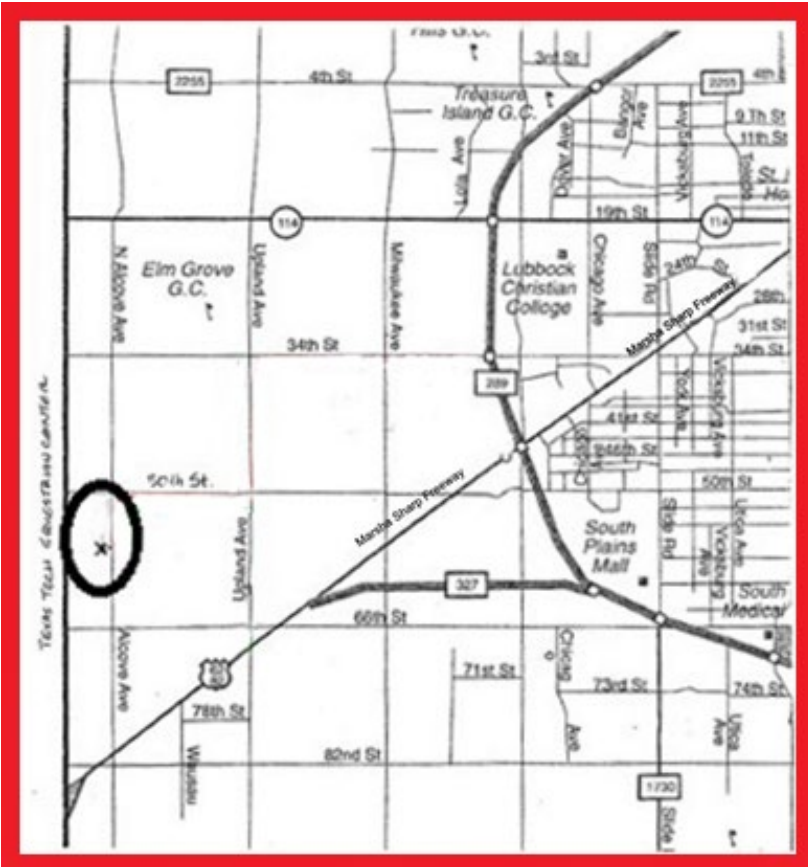

**FROM WEST LOOP 289:** Take the Marsha Sharp Freeway Exit and go west to Upland Avenue. Go right on Upland Avenue, 1 mile on Upland to 50th Street. Left at the Stop sign on 50th St. Go west on 50th St. 1 mile to Alcove Ave. Left on Alcove and go south ½ mile to the entrance to the Equestrian Center. Proceed to the parking lot

**FROM HWY 62/82 SOUTHWEST OF LUBBOCK:** Turn north on to Upland Avenue and travel 1.1 miles to the Stop sign at 50th Street. Turn left on 50th St., and go 1 mile to Alcove Ave. Turn left on Alcove and go south ½ mile to the entrance to the Equestrian Center. Proceed to the parking lot.

### ABOUT THE SHOW SITE:

The Texas Tech Equestrian Center is an Indoor Arena with a Dirt arena surface. It is NOT climate controlled, but there are heaters above the bleachers. Please Park in designated Exhibitor parking areas only. Parking is a short distance from the arena, you may want to bring a cart/dolly.

**INDOOR SET UP RESTRICTIONS:** No matting allowed on concrete; matting is allowed on the dirt. Please cover crates with sheet from home. Please endeavor to keep barking at a minimum. No high-backed chairs (i.e., La Fuma style) lounge chairs allowed at ring side.

## AREA MOTEL LISTING

The South Plains Obedience Training Club cannot guarantee that the hotels/motels listed below accept dogs. Please check regarding rates and dog acceptance policy when making reservations.

**NOTICE: Unfortunately, there is a Texas Tech home football game on Saturday of this agility trial. This means that hotel prices are going to be really expensive and scarce. SPOTC HAS ARRANGED FOR THE FOLLOWING SPECIAL PRICES:**

**THE LATER YOU MAKE YOUR RESERVATIONS,  
THE HIGHER THE PRICES GO FOR ALL HOTELS!**

**MCM Elegante Hotel & Suites** 801 Ave Q Lubbock, TX 79401 .....806-763-1200  
There will be 20 double Queen rooms blocked off for SPOTC at a rate of \$79/night +tax.

**YOU MUST MAKE YOUR RESERVATION BEFORE OCTOBER 20 TO GET THIS RATE.  
MENTION THAT YOU ARE HERE FOR THE SPOTC AGILITY TRIAL.**

<b>Baymont by Wyndham</b> , 601 Ave Q, Lubbock, TX 79401 .....	806-763-9441
<b>La Quinta</b> 6504 Interstate 27 S, Lubbock, Texas 79412 .....	806-776-9100
<b>La Quinta Inn &amp; Suites</b> , 5006 Auburn St, Lubbock, TX 79416.....	806.749.1600
<b>La Quinta Inn &amp; Suites West/Medical Center</b> , 4115 Marsha Sharp Fwy, Lubbock TX 79407.....	806.792.0065
<b>Motel 6</b> , 1-27 & 66th Street, Lubbock TX79412.....	806.745-5541
<b>Best Western Lubbock Windsor Inn</b> , 5410 I- 27, Lubbock, TX 79404.....	806.762.8400
<b>Super 8 Civic Center</b> . 501 Avenue Q, Lubbock, TX 79401.....	806.762.8726
<b>Four Points Hotel Sheraton</b> , 505 Avenue Q, Lubbock, TX 79401.....	806. 747.0171
<b>Days Inn</b> , 2401 - 4th Street, Lubbock, TX, 79415.....	806.747.7111
<b>Studio 6 Motel</b> , 4521 Marsha Sharp Frwy, Lubbock, TX 79401.....	806-687-6666 or 888.897.0202

Exhibitors are expected to maintain their premises and their dogs in a quiet, clean and well-kept manner. Complaints lodged against any exhibitor will be under the auspices of our Trial Committee and reported to the AKC. Exhibitors are responsible for cleaning up after their dogs at the trial site and all motels.

### RV INFORMATION:

There are 29 Electric-only hookups at the show site available for \$25/night. Call the arena office at 806-792-4682 or email Christina Butler at [christina.butler@ttu.edu](mailto:christina.butler@ttu.edu) for reservations. First come, first served. The Arena Secretary will confirm if you have a reservation. No confirmation, no reservation.

<b>Loop 289 RV Park</b> , 3436 West Loop 289, Lubbock, TX 79404.....	806.792.4348
<b>KOA Kamp ground</b> , 5502 County Road 6300, Lubbock, TX 79416.....	806.762.8653
(2.5 mi west of Loop 289 on Hwy 84)	

---

## FEO AND FIX AND GO ON

**As of January 1, 2021 For Exhibition only (FEO) and Fix and Go On are permanent parts of the AKC Agility program.**

### **Entering for Exhibition Only (FEO)**

FEO allows exhibitors to work with their dogs in a trial environment. FEO is only offered in the Time 2 Beat and FAST classes. Participation in FEO is non-qualifying.

- FEO runs are treated as trial entries. The exhibitor must enter the class(es) (T2B and/or FAST) prior to the closing date, pay class entry fee(s) and the Trial Secretary must record the entry in the Trial Catalog as part of the results for that class. FEO does not need to be noted on the entry form; the handler will declare the day of the show.
- Dogs may be entered in any jump height for FEO runs. If entered in an ineligible jump height, the team is committed to FEO for that run and must declare FEO on the start line. Day of show jump height changes are not allowed.
- Dogs may be entered in any level of FAST (Novice, Open, Excellent, Master). If the dog is not eligible for the level entered, the team is committed to FEO for that run and must declare FEO on the start line. Day of show level changes are not allowed.
- The exhibitor must declare FEO in the ring prior to leading out. FEO may be declared earlier (ex. when checking in at the gate board).
- Toys are allowed in the ring. Toys must be non-audible and may not leave the handlers hand. Toys that roll freely may not be used.
- Food/treats are not allowed in the ring
- FEO should be utilized for the benefit of the dog and not as a punitive correction. Harsh verbal and /or physical corrections shall not be tolerated. Any determination of harshness by the judge shall be immediately whistled and the handler will be dismissed from the ring.
- A judge must monitor the entire run. Judges can stop a run at any time

### **Fix and Go On**

Fix and Go On allows exhibitors to immediately reattempt an obstacle at any time while on course when the dog's performance of an obstacle is not to their expectation. This allows the dog to successfully complete the obstacle then finish the course or leave the ring on a positive note Using Fix and Go On will result in a non-qualifying score. Fix and Go On is not pre-entered; rather, it occurs during the run.



**OFFICIAL AMERICAN KENNEL CLUB AGILITY ENTRY FORM**  
**SOUTH PLAINS OBEDIENCE TRAINING CLUB**

Opens: Wed. Sept 7, 2022 at 8:00 AM; Closes Wed., October 26, 2022 6:00 PM

**DAILY FEES:** 1 Class-\$25; 2 Classes-\$40; 3 Classes-\$55; 4 Classes-\$70; 5 - \$85; 6 - \$100

	STD	JWW	FAST	T2B	PREM STD	PREM JWW
Fri, Nov 11 2022	<input type="checkbox"/>	<input type="checkbox"/>	<input type="checkbox"/>	<input type="checkbox"/>	<input type="checkbox"/>	<input type="checkbox"/>
Sat., Nov 12, 2022	<input type="checkbox"/>	<input type="checkbox"/>	N/A	<input type="checkbox"/>	<input type="checkbox"/>	<input type="checkbox"/>
Sun., Nov 13 2022	<input type="checkbox"/>	<input type="checkbox"/>	<input type="checkbox"/>	N/A	N/A	N/A

Make checks payable to: **SPOTC** Mail to: Sherri Farmer, PO Box 1720, Wylie, TX 75098-1720

IMPORTANT: Carefully read instructions before filling out!

24"Choice is OWNER OPTION for dogs 22" or UNDER at the withers

ENTRY FEE ENCLOSED

\$ \_\_\_\_\_

**Choose Either Regular OR Preferred Classes**

Check one jump height, and check class selections :: Only one selection per class (STD, JWW, FAST, T2B)

REGULAR Classes	PREFERRED Classes
<input type="checkbox"/> 8" <input type="checkbox"/> 12" <input type="checkbox"/> 16" <input type="checkbox"/> 20" <input type="checkbox"/> 24" <input type="checkbox"/> 24"Choice	<input type="checkbox"/> 4" <input type="checkbox"/> 8" <input type="checkbox"/> 12" <input type="checkbox"/> 16" <input type="checkbox"/> 20"
STD <input type="checkbox"/> Nov A <input type="checkbox"/> Nov B <input type="checkbox"/> Open <input type="checkbox"/> Exc <input type="checkbox"/> Mas <input type="checkbox"/> Prem	<input type="checkbox"/> NovP <input type="checkbox"/> OpenP <input type="checkbox"/> ExcP <input type="checkbox"/> MasP <input type="checkbox"/> PremP
JWW <input type="checkbox"/> Nov A <input type="checkbox"/> Nov B <input type="checkbox"/> Open <input type="checkbox"/> Exc <input type="checkbox"/> Mas <input type="checkbox"/> Prem	<input type="checkbox"/> NovP <input type="checkbox"/> OpenP <input type="checkbox"/> ExcP <input type="checkbox"/> MasP <input type="checkbox"/> PremP
FAST <input type="checkbox"/> Nov A <input type="checkbox"/> Nov B <input type="checkbox"/> Open <input type="checkbox"/> Exc <input type="checkbox"/> Mas	<input type="checkbox"/> NovP <input type="checkbox"/> OpenP <input type="checkbox"/> ExcP <input type="checkbox"/> MasP
T2B <input type="checkbox"/>	T2B-P <input type="checkbox"/>

This Dog Needs To Be Measured  Yes  No

SEX

HEIGHT AT WITHERS

BREED

VARIETY

CALL NAME

AKC® NAME (INCLUDE AKC TITLES ONLY)

AKC® NO

Enter Complete Registration # below

DATE OF BIRTH

ILP NO.  PAL NO.

PLACE OF BIRTH (LIST COUNTRY)

FOREIGN REG. NO & COUNTRY

BREEDER

SIRE

DAM

ACTUAL OWNERS

OWNERS ADDRESS

NEW ADDRESS

CITY, STATE ZIP + 4

HANDLER

ENTER JR. HANDLER # if applicable

Exhibitor or owner MUST sign on the signature line beneath the instructions.

**THIS IS A FILLABLE FORM. CLICK ON BOXES TO SELECT; TYPE INFO ON LINES**

AKC Rules, Regulations, Policies and Guidelines are available on the American Kennel Club Web site, [www.akc.org](http://www.akc.org).

**AGREEMENT**

I certify that I am the actual owner of the dog, or that I am the duly authorized agent of the actual owner whose name I have entered. In consideration of the acceptance of this entry, I (we) agree to abide by the rules and regulations of The American Kennel Club in effect at the time of this event, and any additional rules and regulations appearing in the premium list of this event and entry form and any decision made in accord with them. I (we) agree that the club holding this event has the right to refuse this entry for cause which the club shall deem sufficient. I (we) certify and represent that the dog entered is not a hazard to persons or other dogs. In consideration of the acceptance of this entry and of the holding of this event and of the opportunity to have the dog judged and to win prizes, ribbons, or trophies, I (we) agree to hold the AKC, the event-giving club, their members, directors, governors, officers, agents, superintendents or event secretary and the owner and/or lessor of the premises and any provider of services that are necessary to hold this event and any employees or volunteers of the aforementioned parties, and any AKC approved judge, judging at this event, harmless from any claim for loss or injury which may be alleged to have been caused directly or indirectly to any person or thing by the act of this dog while in or about the event premises or grounds or near any entrance thereto, and I (we) personally assume all responsibility and liability for any such claim; and I (we) further agree to hold the aforementioned parties harmless from any claim for loss, injury or damage to this dog.

Additionally, I (we) hereby assume the sole responsibility for and agree to indemnify, defend and save the aforementioned parties harmless from any and all loss and expense (including legal fees) by reason of the liability imposed by law upon any of the aforementioned parties for damage because of bodily injuries, including death at any time resulting therefrom, sustained by any person or persons, including myself (ourselves), or on account of damage to property, arising out of or in consequence of my (our) participation in this event, however such, injuries, death or property damage may be caused, and whether or not the same may have been caused or may be alleged to have been caused by the negligence of the aforementioned parties or any of their employees, agents, or any other person. I (WE) AGREE THAT ANY CAUSE OF ACTION, CONTROVERSY OR CLAIM ARISING OUT OF OR RELATED TO THE ENTRY, EXHIBITION OR ATTENDANCE AT THE EVENT BETWEEN THE AKC AND THE EVENT-GIVING CLUB (UNLESS OTHERWISE STATED IN THIS PREMIUM LIST) AND MYSELF (OURSELVES) OR AS TO THE CONSTRUCTION, INTERPRETATION AND EFFECT OF THIS AGREEMENT SHALL BE SETTLED BY ARBITRATION PURSUANT TO THE APPLICABLE RULES OF THE AMERICAN ARBITRATION ASSOCIATION. HOWEVER, PRIOR TO ARBITRATION ALL APPLICABLE AKC BYLAWS, RULES, REGULATIONS AND PROCEDURES MUST FIRST BE FOLLOWED AS SET FORTH IN THE AKC CHARTER AND BYLAWS, RULES, REGULATIONS, PUBLISHED POLICIES AND GUIDELINES.

**INSTRUCTIONS**

Handlers whose dogs measure into the 8" through 20" regular jump height divisions may opt to enter in a higher or 24-choice height division for all Regular titling classes, but not in a division lower than their proper height division. Dogs who measure into the 24" regular jump height division may not enter 24-choice. Dogs entered in the Preferred classes must compete at the required jump height and may not compete in a jump height division higher or lower than their proper height division.

All dogs that have not been officially measured for an Agility Jump Height Card may still compete; however, they must be measured by a Judge of record, an Agility Field Representative, or a Volunteer Measuring Official, prior to running. If measured by the Judge of record, that measurement will be valid for this trial or back-to-back trials only. If a measurement is necessary, it is the exhibitor's responsibility to have their dog(s) measured prior to running.

Dogs listed in the **AKC Canine Partners Program<sup>SM</sup>** may be eligible to enter all-breed AKC agility trials at the club's option. These dogs should be listed as All American Dog and must include their AKC number on the entry form and check the AKC No. box.

Junior Handlers should enter their Junior Handler Number on the front of this form. Should you not have your Junior Handler number, it may be obtained from the American Kennel Club (919) 233-9767. If the Junior Handler is not the owner of the dog identified on the face of this form, what is the relationship of the Junior Handler to the Owner? \_\_\_\_\_

SIGNATURE of owner or his agent duly authorized to make this entry.

**SIGN HERE X** \_\_\_\_\_

Telephone Number: \_\_\_\_\_

Email \_\_\_\_\_  New Email

In Case of Emergency - Name: \_\_\_\_\_ Phone # \_\_\_\_\_

AEAGL2 (10/17)

**\*\*NEW ENTRY FORM REQUIRED FOR CHANGE IN JUMP HEIGHT FOR CLASSES.\*\***





OFFICIAL AMERICAN KENNEL CLUB AGILITY ENTRY FORM

SOUTH PLAINS OBEDIENCE TRAINING CLUB

Opens: Wed. Sept 7, 2022 at 8:00 AM; Closes Wed., October 26, 2022 6:00 PM

DAILY FEES: 1 Class-\$25; 2 Classes-\$40; 3 Classes-\$55; 4 Classes-\$70; 5 - \$85; 6 - \$100

Table with columns for dates (Fri, Nov 11, 2022; Sat, Nov 12, 2022; Sun, Nov 13, 2022) and checkboxes for class types (STD, JWW, FAST, T2B, PREM STD, PREM JWW).

Make checks payable to: SPOTC Mail to: Sherri Farmer, PO Box 1720, Wylie, TX 75098-1720

IMPORTANT: Carefully read instructions before filling out!

ENTRY FEE ENCLOSED

24"Choice is OWNER OPTION for dogs 22" or UNDER at the withers

\$ \_\_\_\_\_

Choose Either Regular OR Preferred Classes

Check one jump height, and check class selections :: Only one selection per class (STD, JWW, FAST, T2B)

Table with columns for REGULAR Classes and PREFERRED Classes, listing options for jump heights (8", 12", 16", 20", 24") and class types (STD, JWW, FAST, T2B).

Form fields for dog information: This Dog Needs To Be Measured (Yes/No), BREED, VARIETY, SEX, HEIGHT AT WITHERS, CALL NAME.

AKC® NAME (INCLUDE AKC TITLES ONLY)

Form fields: AKC® NO, Enter Complete Registration # below, DATE OF BIRTH.

Form fields: ILP NO, PAL NO, PLACE OF BIRTH (LIST COUNTRY).

Form fields: FOREIGN REG. NO & COUNTRY, BREEDER.

Form fields: SIRE, DAM.

Form fields: ACTUAL OWNERS.

Form fields: OWNERS ADDRESS, NEW ADDRESS checkbox.

Form fields: CITY, STATE ZIP + 4.

Form fields: HANDLER, ENTER JR. HANDLER # if applicable.

Exhibitor or owner MUST sign on the signature line beneath the instructions.

THIS IS A FILLABLE FORM. CLICK ON BOXES TO SELECT; TYPE INFO ON LINES

AKC Rules, Regulations, Policies and Guidelines are available on the American Kennel Club Web site, www.akc.org.

AGREEMENT

I certify that I am the actual owner of the dog, or that I am the duly authorized agent of the actual owner whose name I have entered. In consideration of the acceptance of this entry, I (we) agree to abide by the rules and regulations of The American Kennel Club in effect at the time of this event...

Additionally, I (we) hereby assume the sole responsibility for and agree to indemnify, defend and save the aforementioned parties harmless from any and all loss and expense (including legal fees) by reason of the liability imposed by law upon any of the aforementioned parties for damage because of bodily injuries, including death at any time resulting therefrom...

INSTRUCTIONS

Handlers whose dogs measure into the 8" through 20" regular jump height divisions may opt to enter in a higher or 24-choice height division for all Regular titling classes, but not in a division lower than their proper height division.

All dogs that have not been officially measured for an Agility Jump Height Card may still compete; however, they must be measured by a Judge of record, an Agility Field Representative, or a Volunteer Measuring Official, prior to running.

Dogs listed in the AKC Canine Partners ProgramSM may be eligible to enter all-breed AKC agility trials at the club's option. These dogs should be listed as All American Dog and must include their AKC number on the entry form and check the AKC No. box.

Junior Handlers should enter their Junior Handler Number on the front of this form. Should you not have your Junior Handler number, it may be obtained from the American Kennel Club (919) 233-9767.

SIGNATURE of owner or his agent duly authorized to make this entry.

SIGN HERE X \_\_\_\_\_

Telephone Number: \_\_\_\_\_

Email \_\_\_\_\_ New Email checkbox

In Case of Emergency - Name: \_\_\_\_\_ Phone # \_\_\_\_\_